

QUICK START GUIDE

1. **Construct mooring:** Refer to Mooring Guide; or use the mooring you purchased from Obscape.

2. **Open top cap:** Unscrew the 3 eye bolts. Lift the white top disc and turn upside-down. Unscrew the 2 hexagonal steel bolts. Lift off the back panel.

3. **Create Data Portal account:** You will have received an automated account creation email from Obscape. Click on the link in the account invitation email. If you have not received this link, please contact Obscape, BEFORE proceeding further.

4. **Log onto Data Portal :** Navigate to <https://www.obscape.com/portal>

5. **Activate device:** Navigate to the **Devices** page and insert the **Activation Code**, which will be visible after lifting the Top Cap.

6. **Create station and Couple the device:** Navigate to your Portal's **Map** page and click on the map to create a station. Click on the station pin and select **Menu** → **Edit devices** → **Couple device**.

7. **Real-time settings:** On your portal's **Map** page, click on the station you have created and then click the **Settings** button.
(Cellular communication only)

8. **Activate satellite line rental:** Activate satellite line rental on your portals **Satellite communication** page.
(Satellite communication only).

9. **SD settings:** If using Satellite comms, Eject SD Card from device, Insert the card into a computer, adjust the settings.
This step is not necessary if you are only using cellular comms.
(Never eject the SD card while the Wave Buoy is powered!)

10. **Insert SIM card: (Cellular communication only)**

11. **Start measurement:** Connect the battery pack and press the power button. The device will beep and the status LED will **blink blue** for 4 seconds before it turns **solid blue** and the device enters the start-up sequence. The OLED display will inform you about the progress of the device's system test. If it passes the system test, after 1 to 2 minutes the device will **blink green** and the buzzer will play the acknowledgement tune.

12. **Close the top cap:** Lubricate the rubber rings with Silicon paste , put the top cap in place and fasten the 6 bolts. Avoid over tightening the bolts.

13. **Monitor data connection:** *Keep the Wave Buoy running for 24hrs to verify stable data transmission. Ensure Wave Buoy is Fully Charged and Communicates , prior to deployment.*

14. **Deploy your Wave Buoy:** Connect the mooring to the buoy and deploy in situ.

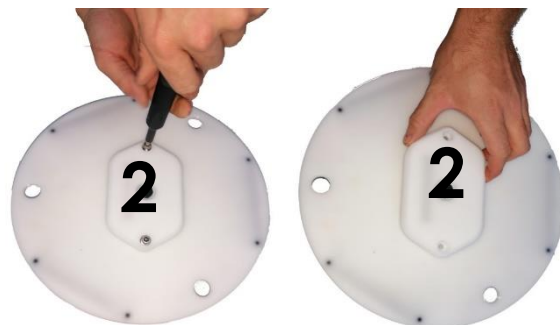

NOTICE: BEFORE DEPLOYING YOUR WAVE BUOY, YOU WILL NEED TO ACTIVATE THE DEVICE ON THE DATA PORTAL FIRST!

It is highly recommended to run your Wave Buoy for 24hrs before deploying in the field.

Refer over for more information, or download the Data Portal Manual and Wave Buoy Manual on the **Support Page:**
<https://obscape.com/portal/support>

Also check out the Quick Start Tutorial movie on the **Support** page for even more detailed instructions.